



# **SERIES 300 Hybrid**

Low Fixed Picture  
High Fixed Picture  
Direct Set Picture

Technical Specifications  
and Cross-Sectional  
Details

**Table of Contents**

- CONSTRUCTIONS SPECIFICATIONS - SECTION 08 54 00 ..... 2
- PART 1 GENERAL ..... 2
  - 1.1. SECTION INCLUDES ..... 2
  - 1.2. REFERENCES ..... 2
  - 1.3. SUBMITTALS ..... 3
  - 1.4. QUALITY ASSURANCE ..... 3
  - 1.5. STORAGE AND HANDLING ..... 3
  - 1.6. WARRANTY ..... 3
- PART 2 PRODUCTS ..... 4
  - 2.1. MANUFACTURED UNITS ..... 4
  - 2.2. FABRICATION ..... 4
- PART 3 EXECUTION ..... 5
  - 3.1. EXAMINATION ..... 5
  - 3.2. INSTALLATION ..... 6
  - 3.3. FIELD QUALITY CONTROL ..... 6
  - 3.4. CLEANING ..... 6
  - 3.5. PROTECTING INSTALLED CONSTRUCTION ..... 6
- WINDOW TYPE AND CLASSIFICATIONS ..... 7
- ENERGY STAR ..... 8
- THERMAL RESULTS ..... 10
  - LOW FIXED PICTURE WINDOW ..... 10
  - HIGH FIXED PICTURE WINDOW ..... 12
  - DIRECT SET PICTURE WINDOW ..... 14
- CROSS SECTIONS ..... 16
  - LOW FIXED PICTURE WINDOW ..... 16
  - HIGH FIXED PICTURE WINDOW ..... 17
  - DIRECT SET PICTURE WINDOW ..... 18
  - MULLING ASSEMBLY ..... 19
  - GRILL + SDL OPTIONS ..... 20
- TEST REPORTS ..... 21

## CONSTRUCTIONS SPECIFICATIONS - SECTION 08 54 00

### PART 1 GENERAL

#### 1.1. SECTION INCLUDES

- A. Series 300 Hybrid Picture Low Fixed Window complete with glazing, mulling options, weather strip, grilles-between-the-glass, jamb extension, exterior brickmould trims, exterior sill extension and standard or specified anchors, trim and attachments
- B. Series 300 Hybrid Picture High Fixed Window complete with glazing, mulling options, weather strip, grilles-between-the-glass, jamb extension, exterior brickmould trims, exterior sill extension and standard or specified anchors, trim and attachments
- C. Series 300 Hybrid Picture Direct Set Window complete with glazing, mulling options, weather strip, grilles-between-the-glass, jamb extension, exterior brickmould trims, exterior sill extension and standard or specified anchors, trim and attachments

#### 1.2. REFERENCES

- A. ASTM International (ASTM)
  - 1. American Society for Testing and Materials (ASTM):
  - 2. C1036: Standard Specification for Flat Glass.
  - 3. E 283: Standard Test Method for Rate of Air Leakage through Exterior Windows, Curtain Walls and Doors.
  - 4. E 330: Standard Test Method for Structural Performance of Exterior Windows, Curtain Walls, and Door by Uniform Static Air Pressure Difference.
  - 5. E 547: Standard Test Method for Water Penetration of Exterior Windows, Curtain Walls, and Doors by Cyclic Static Air Pressure Differential.
  - 6. E 2190: Standard Specification for Insulating Glass Unit Performance Evaluation.
  - 7. F 2090-10: Standard Specification for Window Fall Prevention Devices with Emergency Escape (Egress) Release Mechanisms.
- D. American Architectural Manufacturer's Association/Window and Door Manufacturer's Association/Canadian Standards Association (AAMA/WDMA/CSA): (use appropriate specifications depending on certification for each product type).
- E. AAMA/WDMA/CSA 101/I.S.2/A440-08/11,S11-09: North American Fenestration Standard/Specification for windows, doors, and skylights.
- F. AAMA 450-10: Voluntary Performance Rating Method for Muller Fenestration Assemblies
- G. Window and Door Manufacturer's Association (WDMA): Keystone Certification Program
- H. Insulating Glass Manufacturer's Alliance/Insulating Glass Certification Council (IGMA/IGCC).

- I. National Fenestration Rating Council (NFRC):
  1. 101: Procedures for Determining Fenestration Product Thermal Properties.
  2. 200: Procedure for Determining Solar Heat Gain Coefficients at Normal Incidence

### 1.3. SUBMITTALS

- A. Shop Drawings: Submit shop drawings.
- B. Samples: Specified performance and design requirements.
- C. Quality Control Submittals: Certificates: Submit manufacturer's certification indicating compliance with specified performance and design requirement

### 1.4. QUALITY ASSURANCE

- A. Requirements: consult local code for NBC [National Building Code] adoption year and pertinent revisions for information on:
- B. Egress, emergency escape and rescue requirements.
- C. Basement window requirements.
- D. Windows fall prevention and/or window opening control device requirements.

### 1.5. STORAGE AND HANDLING

- A. Applicable frames and muller units will include additional bracing to maintain squareness and rigidity during shipment.
- B. Store window units in an upright position in a clean and dry storage area above ground to protect from weather.

### 1.6. WARRANTY

**The following limited warranty is subject to conditions and exclusions. There are certain conditions or applications over which EVERLAST Group of Companies has no control. Defect or problems as a result of such conditions or applications are not the responsibility of EVERLAST Groups of Companies. For a more complete description of the EVERLAST limited warranty, refer to the complete and current warranty information available by request.**

Clear insulating glass with stainless steel spacers is warranted against seal failure caused by manufacturing defects and resulting in visible obstruction through the glass for twenty (20) years from the original date of purchase. Glass is warranted against stress cracks caused by manufacturing defects for ten (10) years from the original date of purchase.

Hardware and other non-glass components are warranted to be free from manufacturing defects for two (2) years from the original date of purchase.

## PART 2 PRODUCTS

### 2.1. MANUFACTURED UNITS

- A. Description: Altitude Picture Fixed units as manufactured by EVERLAST Group of Companies
- Calgary, Alberta, Canada

### 2.2. FABRICATION

A. Frame:

1. Frame – Vinyl: members shall be manufactured from .079" [2mm] extruded unplasticized polyvinylchloride (uPVC). Frame corners shall be fusion welded and cleaned.
2. Frame Depth – Vinyl: Frame shall have standard jamb depth of 2-1/4" [57.15mm] with integral nailing fin and an overall profile thickness of 3-1/4" [83mm].
3. Frame Exterior Cladding: Manufactured from 0.070" [2mm] extruded aluminum.
4. Frame Glazing Tower Exterior Cladding: Manufactured from 0.070" [2mm] extruded aluminum.
5. Interior and exterior frame expander accessory is factory installed.
6. Interior and exterior fabricated frame expander components, including head-jamb, sill and both jamb components.

B. GLAZING

1. Select quality complying with ASTM C 1036. Insulating glass SIGMA/IGCC when tested in accordance with ASTM E 2190. STC/OITC ratings are tested to the stated performance level in accordance with ASTM E 90-09.
2. Glazing Method: 7/8" (22mm), 1" (25.4mm) and 1 1/4" (31.75mm) insulating glass. Dual and Triple glazing.
3. Glass Type: LoE Cardinal IG® i89, 180, 270, 272 and 366 with Air or Argon Gas.
4. Glass Type Options: Obscure Glass, Sand Blasted, Rain Glass, Glue Chip, Narrow Reed, Reed, Bronze Tint, Gray Tint, Green Tint.
5. Glazing Seal: Silicone bead at exterior; interior has glazing boot inserted.
6. Perimeter Spacer: Default color is mill finish (stainless).
7. Glazing Option: STC/OITC upgrade.

C. MULLING

1. Directional mull limits: 6 wide by 1 unit high; Rough Opening not to exceed 114" x 84" (2896mm x 2134mm).
2. Directional mull limits: 5 units wide by 5 units high: Rough Opening not to exceed 96" x 84" (2438mm x 2134mm).

D. FINISH

1. Exterior: Aluminum clad. Duracron topcoat applied over primer. Meets or exceeds AAMA 2605 requirements.

2. Interior: Aluminum clad. Duracron topcoat applied over primer. Meets or exceeds AAMA 2605 requirements.
3. Colour: Various colours available, contact an Everlast representative for more details.

**E. WEATHER STRIP**

1. Primary weather strip is an extruded bulb attached to all four sides of the glazing tower by a kerf and provides seal between frame and insulated sealed unit..
2. Standard weather strip color: black.

**F. JAMB EXTENSION**

1. Standard: factory-installed jamb extension; various sizes and finishes available.

**G. GRILLES-BETWEEN-THE-GLASS**

1. Manufactured from aluminum profile placed between the two panes of glass.
  - a) Interior Colours : Various colours, including split finishes are available.
  - b) Exterior Colours: Various colours, including split finishes are available.
  - c) Profiles: Various profile shapes are available, contact an Everlast representative.
  - d) Pattern: Various patterns are available, contact an Everlast representative.

**H. SIMULATED DIVIDED LITES (SDL)**

- a) Size: 1" (25mm) wide, 2" (50mm) wide with or w/out internal spacer bar; w/out is standard.
- b) Colours: Various standard and custom colours available, contact an EVERLAST representative.

**I. ACCESSORIES AND TRIM**

1. Exterior Casing:
2. Offset brickmould available in standard and custom colors.
3. Installation Accessories:
4. Factory-installed aluminum nailing fin at head, sill and side jambs.
5. Installation brackets
6. Mullion kit: standard mullion kit for filed assembly of related units available. Kit includes: Instruction, interior and exterior mull covers and brackets.

## **PART 3 EXECUTION**

### **3.1. EXAMINATION**

- A. Verification of Condition: Before installation, verify openings are plumb, square and of proper dimensions. Report frame defects or unsuitable conditions to the General Contractor and/or Everlast directly before proceeding. Damages or defects must be reported within 72 hours of receipt of finished goods.
- B. Acceptance of Condition: Beginning installation or no notification within the 72 hours confirms acceptance of existing conditions.

### **3.2. INSTALLATION**

- A. Assemble and install window/door unit(s) according to manufacturer's instruction and reviewed shop drawing.
- B. Install sealant and related backing materials at perimeter of unit or assembly in accordance to reviewed shop drawings.
- C. Install accessory items as required.

### **3.3. FIELD QUALITY CONTROL**

- A. Remove visible labels and adhesive residue according to manufacturers' instruction
- B. Unless otherwise specified, water penetration resistance testing shall be conducted per AAMA 502 and ASTM E1105 at 2/3 of the fenestration products design pressure (DP) rating. Water penetration shall be defined in accordance with the test method(s) applied.

### **3.4. CLEANING**

- A. Remove visible labels and adhesive residue according to manufacturer's instruction.
- B. Leave windows and glass in a clean condition.

### **3.5. PROTECTING INSTALLED CONSTRUCTION**

- A. Protecting windows from damage by chemicals, solvents, paint or other construction operations that may cause damage.

**END OF SECTION**

**WINDOW TYPE AND CLASSIFICATIONS**

Design Performance Classifications

| Product            | Air Tested (psf) | Water Tested (Pa) | Design Pressure (Pa / psf) |    | Cert. Rating | Test Size         |      |                    |      |
|--------------------|------------------|-------------------|----------------------------|----|--------------|-------------------|------|--------------------|------|
|                    |                  |                   |                            |    |              | Max Overall Width |      | Max Overall Height |      |
|                    |                  |                   |                            |    |              | in                | mm   | in                 | mm   |
| Low Picture (LFP)  | FIXED            | 730               | 2880/<br>-2880             | 60 | CW-PG60      | 78                | 1981 | 72                 | 1828 |
| High Picture (HFP) | FIXED            | 730               | 4080/<br>-4080             | 85 | CW-PG85      | 78                | 1980 | 72                 | 1830 |
| Direct Set (DSP)   | FIXED            | 730               | 2880/<br>-2880             | 60 | CW-PG60      | 78                | 1981 | 72                 | 1828 |



## ENERGY STAR

### ENERGY STAR® Program - Canada

This technical specification determines how residential windows, doors, and skylights sold in Canada are certified for the ENERGY

STAR® program. This specification is issued by Natural Resources Canada (NRCan). NRCan has been authorized by the U.S. Environmental Protection Agency (EPA) to promote and administer the ENERGY STAR name and symbol in Canada. A product must meet this specification in order to be promoted as ENERGY STAR certified in Canada by its manufacturer or authorized agent. Manufacturers must also sign a Fenestration Administrative Arrangement with NRCan.

### Performance metrics

**U-Factor:** The heat transfer per time per area and per degree of temperature difference in  $W/m^2 \cdot K$  ( $Btu/h \text{ ft}^2 \cdot ^\circ F$ ). The U-factor multiplied by the interior-external temperature difference and by the projected fenestration product area yields the total heat transfer

through the fenestration product due to conduction, convection, and long-wave infra-red radiation. A U-factor in  $Btu/h \text{ ft}^2 \cdot ^\circ F$  multiplied by 5.678263 converts the value to  $W/m^2 \cdot K$ . The U-factor in  $Btu/h \text{ ft}^2 \cdot ^\circ F$  shall conform with Table 1 before the conversion to  $W/m^2 \cdot K$ .

**Solar heat gain coefficient (SHGC):** The ratio of the solar heat gain entering the space through the fenestration product to the incident solar radiation.

**Air leakage:** the flow of air that passes through fenestration products in  $L/s/m^2$ . Air leakage infiltration is the flow of air into the building envelope and exfiltration is the flow of air out of the building envelope. An air leakage in  $cfm/ft^2$  multiplied by 5.08 converts the value to  $L/s/m^2$ . The air leakage value in  $cfm/ft^2$  shall conform with Table 1 before the conversion to  $L/s/m^2$ .

**Energy rating (ER):** a unitless value derived from a formula that balances heat loss (U-factor), air leakage loss and potential passive solar gain of a fenestration product. The ER is applied to fenestration systems intended to be installed in a vertical orientation in low-rise residential buildings. The simplified ER equation is as follows:

$$ER = (57.76 \times SHGC_w) - (21.90 \times U_w) - (1.97 \times L_{75}) + 40 \text{ where}$$

- $SHGC_w$  = fenestration system solar heat gain coefficient
- $U_w$  = fenestration system U-factor ( $W/m^2$ )
- $L_{75}$  = fenestration system air leakage rate at a pressure difference of 75 Pa, established in accordance with AAMA/WDMA/CSA 101/I.S.2/A440 (North American Fenestration Standard) in  $L/s \cdot m^2$ . The  $L_{75}$  shall be the average of the infiltration and exfiltration measurements.

A complete explanation of the ER equation may be found in the CSA A440.2 Standard.

U-factor Criteria for Residential Windows and Doors

| Product           | Maximum U-factor<br>W/m <sup>2</sup> ·K | Maximum U-factor<br>Btu/h·ft <sup>2</sup> ·°F |
|-------------------|---|---|
| Windows and Doors | 1.22                                    | 0.21  |

Alternate ER Criteria for Residential Windows and Doors

| Product           | Minimum ER (unitless) |
|-------------------|-----------------------|
| Windows and Doors | 34                    |

U-factor Criteria for Unit Skylights

| Product   | Maximum U-factor<br>W/m <sup>2</sup> ·K | Maximum U-factor<br>Btu/h·ft <sup>2</sup> ·°F |
|-----------|---|---|
| Skylights | 2.29                                    | 0.4   |

THERMAL RESULTS

LOW FIXED PICTURE WINDOW

| Mfr Product Code                               | Product Number | Gap 1 (in) | Gap 2 (in) | Gap Fill 1 | Gap Fill 2 | Emissivity Surface 2 | Emissivity Surface 3 | Emissivity Surface 4 | Emissivity Surface 5 | Emissivity Surface 6 | Tint | Spacer | Grid Type | Grid Size | U-Factor (Btu/h <sup>2</sup> *F) | SHGC | VT   | *CR |
|--|----------------|------------|------------|------------|------------|----------------------|----------------------|----------------------|----------------------|----------------------|------|--------|-----------|-----------|----------------------------------|------|------|-----|
| CCI-arg97-180 3-3, ga                          | 0001           | 0.65       |            | ARG        |            |                      | 0.068                |                      |                      |                      | CL   | SP-D   | N         |           | 0.27                             | 0.59 | 0.68 | 61  |
| CCI-arg97-180 3-3, ga, Rectangular             |                | 0.65       |            | ARG        |            |                      | 0.068                |                      |                      |                      | CL   | SP-D   | G 0.75    |           | 0.27                             | 0.54 | 0.61 | 61  |
| CCI-arg97-180 4-4, ga                          | 0002           | 0.57       |            | ARG        |            |                      | 0.068                |                      |                      |                      | CL   | SP-D   | N         |           | 0.27                             | 0.58 | 0.68 | 60  |
| CCI-arg97-180 4-4, ga, Rectangular             |                | 0.57       |            | ARG        |            |                      | 0.068                |                      |                      |                      | CL   | SP-D   | G 0.75    |           | 0.27                             | 0.52 | 0.61 | 60  |
| CCI-arg97-180 5-5, ga                          | 0003           | 0.49       |            | ARG        |            |                      | 0.068                |                      |                      |                      | CL   | SP-D   | N         |           | 0.27                             | 0.57 | 0.67 | 59  |
| CCI-arg97-180 5-5, ga, Rectangular             |                | 0.49       |            | ARG        |            |                      | 0.068                |                      |                      |                      | CL   | SP-D   | G 0.75    |           | 0.27                             | 0.51 | 0.60 | 59  |
| 270-arg97-CCI 3-3, ga                          | 0004           | 0.65       |            | ARG        |            | 0.035                |                      |                      |                      |                      | CL   | SP-D   | N         |           | 0.26                             | 0.32 | 0.60 | 61  |
| 270-arg97-CCI 3-3, ga, Rectangular             |                | 0.65       |            | ARG        |            | 0.035                |                      |                      |                      |                      | CL   | SP-D   | G 0.75    |           | 0.26                             | 0.29 | 0.54 | 61  |
| 270-arg97-CCI 4-4, ga                          | 0005           | 0.57       |            | ARG        |            | 0.035                |                      |                      |                      |                      | CL   | SP-D   | N         |           | 0.26                             | 0.31 | 0.60 | 60  |
| 270-arg97-CCI 4-4, ga, Rectangular             |                | 0.57       |            | ARG        |            | 0.035                |                      |                      |                      |                      | CL   | SP-D   | G 0.75    |           | 0.26                             | 0.28 | 0.53 | 60  |
| 270-arg97-CCI 5-5, ga                          | 0006           | 0.49       |            | ARG        |            | 0.035                |                      |                      |                      |                      | CL   | SP-D   | N         |           | 0.26                             | 0.31 | 0.59 | 59  |
| 270-arg97-CCI 5-5, ga, Rectangular             |                | 0.49       |            | ARG        |            | 0.035                |                      |                      |                      |                      | CL   | SP-D   | G 0.75    |           | 0.26                             | 0.28 | 0.53 | 59  |
| 366-arg97-CCI 3-3, ga                          | 0007           | 0.65       |            | ARG        |            | 0.020                |                      |                      |                      |                      | CL   | SP-D   | N         |           | 0.26                             | 0.23 | 0.56 | 62  |
| 366-arg97-CCI 3-3, ga, Rectangular             |                | 0.65       |            | ARG        |            | 0.020                |                      |                      |                      |                      | CL   | SP-D   | G 0.75    |           | 0.26                             | 0.21 | 0.50 | 62  |
| 366-arg97-CCI 4-4, ga                          | 0008           | 0.57       |            | ARG        |            | 0.020                |                      |                      |                      |                      | CL   | SP-D   | N         |           | 0.26                             | 0.24 | 0.55 | 61  |
| 366-arg97-CCI 4-4, ga, Rectangular             |                | 0.57       |            | ARG        |            | 0.020                |                      |                      |                      |                      | CL   | SP-D   | G 0.75    |           | 0.26                             | 0.21 | 0.50 | 61  |
| 366-arg97-CCI 5-5, ga                          | 0009           | 0.49       |            | ARG        |            | 0.020                |                      |                      |                      |                      | CL   | SP-D   | N         |           | 0.25                             | 0.24 | 0.55 | 60  |
| 366-arg97-CCI 5-5, ga, Rectangular             |                | 0.49       |            | ARG        |            | 0.020                |                      |                      |                      |                      | CL   | SP-D   | G 0.75    |           | 0.25                             | 0.21 | 0.49 | 60  |
| 180-arg97-i89 3-3, ga                          | 0010           | 0.65       |            | ARG        |            | 0.068                |                      | 0.149                |                      |                      | CL   | SP-D   | N         |           | 0.22                             | 0.54 | 0.67 | 48  |
| 180-arg97-i89 3-3, ga, Rectangular             |                | 0.65       |            | ARG        |            | 0.068                |                      | 0.149                |                      |                      | CL   | SP-D   | G 0.75    |           | 0.22                             | 0.49 | 0.60 | 48  |
| 180-arg97-i89 4-4, ga                          | 0011           | 0.57       |            | ARG        |            | 0.068                |                      | 0.149                |                      |                      | CL   | SP-D   | N         |           | 0.22                             | 0.52 | 0.66 | 47  |
| 180-arg97-i89 4-4, ga, Rectangular             |                | 0.57       |            | ARG        |            | 0.068                |                      | 0.149                |                      |                      | CL   | SP-D   | G 0.75    |           | 0.22                             | 0.47 | 0.59 | 47  |
| 180-arg97-CCI-arg97-CCI 3-3-3, ga              | 0012           | 0.45       | 0.45       | ARG        | ARG        | 0.068                |                      |                      |                      |                      | CL   | SP-D   | N         |           | 0.21                             | 0.51 | 0.63 | 68  |
| 180-arg97-CCI-arg97-CCI 3-3-3, ga, Rectangular | 0013           | 0.45       | 0.45       | ARG        | ARG        | 0.068                |                      |                      |                      |                      | CL   | SP-D   | G 0.75    |           | 0.22                             | 0.46 | 0.56 | 68  |
| 270-arg97-CCI-arg97-180 3-3-3, ga              | 0014           | 0.45       | 0.45       | ARG        | ARG        | 0.035                |                      |                      | 0.068                |                      | CL   | SP-D   | N         |           | 0.16                             | 0.29 | 0.53 | 75  |
| 270-arg97-CCI-arg97-180 3-3-3, ga, Rectangular | 0015           | 0.45       | 0.45       | ARG        | ARG        | 0.035                |                      |                      | 0.068                |                      | CL   | SP-D   | G 0.75    |           | 0.16                             | 0.26 | 0.48 | 75  |
| 270-arg97-CCI-arg97-CCI 3-3-3, ga              | 0016           | 0.45       | 0.45       | ARG        | ARG        | 0.035                |                      |                      |                      |                      | CL   | SP-D   | N         |           | 0.20                             | 0.29 | 0.55 | 69  |
| 270-arg97-CCI-arg97-CCI 3-3-3, ga, Rectangular | 0017           | 0.45       | 0.45       | ARG        | ARG        | 0.035                |                      |                      |                      |                      | CL   | SP-D   | G 0.75    |           | 0.21                             | 0.27 | 0.49 | 69  |
| 270-arg97-CCI-arg97-270 3-3-3, ga              | 0018           | 0.45       | 0.45       | ARG        | ARG        | 0.035                |                      |                      | 0.035                |                      | CL   | SP-D   | N         |           | 0.15                             | 0.27 | 0.47 | 75  |
| 270-arg97-CCI-arg97-270 3-3-3, ga, Rectangular | 0019           | 0.45       | 0.45       | ARG        | ARG        | 0.035                |                      |                      | 0.035                |                      | CL   | SP-D   | G 0.75    |           | 0.16                             | 0.25 | 0.42 | 75  |
| 366-arg97-CCI-arg97-CCI 3-3-3, ga              | 0020           | 0.45       | 0.45       | ARG        | ARG        | 0.020                |                      |                      |                      |                      | CL   | SP-D   | N         |           | 0.20                             | 0.22 | 0.51 | 69  |

| Mfr Product Code                               | Product Number | Gap 1 (in) | Gap 2 (in) | Gap Fill 1 | Gap Fill 2 | Emissivity Surface 2 | Emissivity Surface 3 | Emissivity Surface 4 | Emissivity Surface 5 | Emissivity Surface 6 | Tint | Spacer | Grid Type | Grid Size | U-Factor (Btu/h-ft <sup>2</sup> -F) | SHGC | VT   | *CR |
|--|----------------|------------|------------|------------|------------|----------------------|----------------------|----------------------|----------------------|----------------------|------|--------|-----------|-----------|-------------------------------------|------|------|-----|
| 366-arg97-CCI-arg97-CCI 3-3-3, ga, Rectangular | 0021           | 0.45       | 0.45       | ARG        | ARG        | 0.020                |                      |                      |                      |                      | CL   | SP-D   | G         | 0.75      | 0.21                                | 0.20 | 0.46 | 69  |
| 366-arg97-CCI-arg97-366 3-3-3, ga              | 0022           | 0.45       | 0.45       | ARG        | ARG        | 0.020                |                      |                      | 0.020                |                      | CL   | SP-D   | N         |           | 0.15                                | 0.21 | 0.40 | 76  |
| 366-arg97-CCI-arg97-366 3-3-3, ga, Rectangular | 0023           | 0.45       | 0.45       | ARG        | ARG        | 0.020                |                      |                      | 0.020                |                      | CL   | SP-D   | G         | 0.75      | 0.15                                | 0.19 | 0.36 | 76  |
| VCI-arg97-SG400 3-3, ga                        | 0024           | 0.65       |            | ARG        |            |                      | 0.113                |                      |                      |                      | CL   | SP-D   | N         |           | 0.29                                | 0.59 | 0.68 | 60  |
| VCI-arg97-SG400 3-3, ga, Rectangular           |                | 0.65       |            | ARG        |            |                      | 0.113                |                      |                      |                      | CL   | SP-D   | G         | 0.75      | 0.29                                | 0.53 | 0.61 | 60  |
| VCI-arg97-SG400 4-4, ga                        | 0025           | 0.57       |            | ARG        |            |                      | 0.113                |                      |                      |                      | CL   | SP-D   | N         |           | 0.29                                | 0.58 | 0.67 | 59  |
| VCI-arg97-SG400 4-4, ga, Rectangular           |                | 0.57       |            | ARG        |            |                      | 0.113                |                      |                      |                      | CL   | SP-D   | G         | 0.75      | 0.29                                | 0.52 | 0.60 | 59  |
| VCI-arg97-SG400 5-5, ga                        | 0026           | 0.49       |            | ARG        |            |                      | 0.113                |                      |                      |                      | CL   | SP-D   | N         |           | 0.28                                | 0.56 | 0.66 | 58  |
| VCI-arg97-SG400 5-5, ga, Rectangular           |                | 0.49       |            | ARG        |            |                      | 0.113                |                      |                      |                      | CL   | SP-D   | G         | 0.75      | 0.28                                | 0.51 | 0.60 | 58  |
| CCI-arg97-180 3-3, im                          | 0027           | 0.65       |            | ARG        |            |                      | 0.068                |                      |                      |                      | CL   | TS-D   | N         |           | 0.28                                | 0.59 | 0.68 | 59  |
| CCI-arg97-180 3-3, im, Rectangular             |                | 0.65       |            | ARG        |            |                      | 0.068                |                      |                      |                      | CL   | TS-D   | G         | 0.75      | 0.28                                | 0.54 | 0.61 | 59  |
| CCI-arg97-180 4-4, im                          | 0028           | 0.56       |            | ARG        |            |                      | 0.068                |                      |                      |                      | CL   | TS-D   | N         |           | 0.27                                | 0.58 | 0.68 | 58  |
| CCI-arg97-180 4-4, im, Rectangular             |                | 0.56       |            | ARG        |            |                      | 0.068                |                      |                      |                      | CL   | TS-D   | G         | 0.75      | 0.27                                | 0.52 | 0.61 | 58  |
| CCI-arg97-180 5-5, im                          | 0029           | 0.48       |            | ARG        |            |                      | 0.068                |                      |                      |                      | CL   | TS-D   | N         |           | 0.27                                | 0.57 | 0.67 | 57  |
| CCI-arg97-180 5-5, im, Rectangular             |                | 0.48       |            | ARG        |            |                      | 0.068                |                      |                      |                      | CL   | TS-D   | G         | 0.75      | 0.27                                | 0.51 | 0.60 | 57  |
| 270-arg97-CCI 3-3, im                          | 0030           | 0.65       |            | ARG        |            | 0.035                |                      |                      |                      |                      | CL   | TS-D   | N         |           | 0.27                                | 0.32 | 0.60 | 60  |
| 270-arg97-CCI 3-3, im, Rectangular             |                | 0.65       |            | ARG        |            | 0.035                |                      |                      |                      |                      | CL   | TS-D   | G         | 0.75      | 0.27                                | 0.29 | 0.54 | 60  |
| 270-arg97-CCI 4-4, im                          | 0031           | 0.56       |            | ARG        |            | 0.035                |                      |                      |                      |                      | CL   | TS-D   | N         |           | 0.26                                | 0.31 | 0.60 | 59  |
| 270-arg97-CCI 4-4, im, Rectangular             |                | 0.56       |            | ARG        |            | 0.035                |                      |                      |                      |                      | CL   | TS-D   | G         | 0.75      | 0.26                                | 0.28 | 0.53 | 59  |
| 270-arg97-CCI 5-5, im                          | 0032           | 0.48       |            | ARG        |            | 0.035                |                      |                      |                      |                      | CL   | TS-D   | N         |           | 0.26                                | 0.31 | 0.59 | 57  |
| 270-arg97-CCI 5-5, im, Rectangular             |                | 0.48       |            | ARG        |            | 0.035                |                      |                      |                      |                      | CL   | TS-D   | G         | 0.75      | 0.26                                | 0.28 | 0.53 | 57  |
| 366-arg97-CCI 3-3, im                          | 0033           | 0.65       |            | ARG        |            | 0.020                |                      |                      |                      |                      | CL   | TS-D   | N         |           | 0.26                                | 0.23 | 0.56 | 60  |
| 366-arg97-CCI 3-3, im, Rectangular             |                | 0.65       |            | ARG        |            | 0.020                |                      |                      |                      |                      | CL   | TS-D   | G         | 0.75      | 0.26                                | 0.21 | 0.50 | 60  |
| 366-arg97-CCI 4-4, im                          | 0034           | 0.56       |            | ARG        |            | 0.020                |                      |                      |                      |                      | CL   | TS-D   | N         |           | 0.26                                | 0.24 | 0.55 | 59  |
| 366-arg97-CCI 4-4, im, Rectangular             |                | 0.56       |            | ARG        |            | 0.020                |                      |                      |                      |                      | CL   | TS-D   | G         | 0.75      | 0.26                                | 0.21 | 0.50 | 59  |
| 366-arg97-CCI 5-5, im                          | 0035           | 0.48       |            | ARG        |            | 0.020                |                      |                      |                      |                      | CL   | TS-D   | N         |           | 0.26                                | 0.24 | 0.55 | 58  |
| 366-arg97-CCI 5-5, im, Rectangular             |                | 0.48       |            | ARG        |            | 0.020                |                      |                      |                      |                      | CL   | TS-D   | G         | 0.75      | 0.26                                | 0.21 | 0.49 | 58  |
| 180-arg97-i89 3-3, im                          | 0036           | 0.65       |            | ARG        |            | 0.068                | 0.149                |                      |                      |                      | CL   | TS-D   | N         |           | 0.23                                | 0.54 | 0.67 | 47  |
| 180-arg97-i89 3-3, im, Rectangular             |                | 0.65       |            | ARG        |            | 0.068                | 0.149                |                      |                      |                      | CL   | TS-D   | G         | 0.75      | 0.23                                | 0.49 | 0.60 | 47  |
| 180-arg97-i89 4-4, im                          | 0037           | 0.56       |            | ARG        |            | 0.068                | 0.149                |                      |                      |                      | CL   | TS-D   | N         |           | 0.23                                | 0.52 | 0.66 | 45  |
| 180-arg97-i89 4-4, im, Rectangular             |                | 0.56       |            | ARG        |            | 0.068                | 0.149                |                      |                      |                      | CL   | TS-D   | G         | 0.75      | 0.23                                | 0.47 | 0.59 | 45  |
| 180-arg97-CCI-arg97-CCI 3-3-3, im              | 0038           | 0.46       | 0.46       | ARG        | ARG        | 0.068                |                      |                      |                      |                      | CL   | TS-D   | N         |           | 0.21                                | 0.51 | 0.63 | 67  |
| 180-arg97-CCI-arg97-CCI 3-3-3, im, Rectangular | 0039           | 0.46       | 0.46       | ARG        | ARG        | 0.068                |                      |                      |                      |                      | CL   | TS-D   | G         | 0.75      | 0.22                                | 0.46 | 0.56 | 67  |
| 270-arg97-CCI-arg97-180 3-3-3, im              | 0040           | 0.46       | 0.46       | ARG        | ARG        | 0.035                |                      | 0.068                |                      |                      | CL   | TS-D   | N         |           | 0.16                                | 0.29 | 0.53 | 73  |
| 270-arg97-CCI-arg97-180 3-3-3, im, Rectangular | 0041           | 0.46       | 0.46       | ARG        | ARG        | 0.035                |                      | 0.068                |                      |                      | CL   | TS-D   | G         | 0.75      | 0.16                                | 0.26 | 0.48 | 73  |
| 270-arg97-CCI-arg97-CCI 3-3-3, im              | 0042           | 0.46       | 0.46       | ARG        | ARG        | 0.035                |                      |                      |                      |                      | CL   | TS-D   | N         |           | 0.21                                | 0.29 | 0.55 | 67  |
| 270-arg97-CCI-arg97-CCI 3-3-3, im, Rectangular | 0043           | 0.46       | 0.46       | ARG        | ARG        | 0.035                |                      |                      |                      |                      | CL   | TS-D   | G         | 0.75      | 0.21                                | 0.27 | 0.49 | 67  |
| 270-arg97-CCI-arg97-270 3-3-3, im              | 0044           | 0.46       | 0.46       | ARG        | ARG        | 0.035                |                      | 0.035                |                      |                      | CL   | TS-D   | N         |           | 0.16                                | 0.27 | 0.47 | 73  |
| 270-arg97-CCI-arg97-270 3-3-3, im, Rectangular | 0045           | 0.46       | 0.46       | ARG        | ARG        | 0.035                |                      | 0.035                |                      |                      | CL   | TS-D   | G         | 0.75      | 0.16                                | 0.25 | 0.42 | 73  |
| 366-arg97-CCI-arg97-CCI 3-3-3, im              | 0046           | 0.46       | 0.46       | ARG        | ARG        | 0.020                |                      |                      |                      |                      | CL   | TS-D   | N         |           | 0.20                                | 0.22 | 0.51 | 68  |
| 366-arg97-CCI-arg97-CCI 3-3-3, im, Rectangular | 0047           | 0.46       | 0.46       | ARG        | ARG        | 0.020                |                      |                      |                      |                      | CL   | TS-D   | G         | 0.75      | 0.21                                | 0.20 | 0.46 | 68  |
| 366-arg97-CCI-arg97-366 3-3-3, im              | 0048           | 0.46       | 0.46       | ARG        | ARG        | 0.020                |                      |                      | 0.020                |                      | CL   | TS-D   | N         |           | 0.15                                | 0.21 | 0.40 | 73  |
| 366-arg97-CCI-arg97-366 3-3-3, im, Rectangular | 0049           | 0.46       | 0.46       | ARG        | ARG        | 0.020                |                      |                      | 0.020                |                      | CL   | TS-D   | G         | 0.75      | 0.16                                | 0.19 | 0.36 | 73  |
| VCI-arg97-SG400 3-3, im                        | 0050           | 0.65       |            | ARG        |            |                      | 0.113                |                      |                      |                      | CL   | TS-D   | N         |           | 0.29                                | 0.59 | 0.68 | 58  |

HIGH FIXED PICTURE WINDOW

| Mfr Product Code                               | Product Number | Gap 1 (in) | Gap 2 (in) | Gap Fill 1 | Gap Fill 2 | Emissivity Surface 2 | Emissivity Surface 3 | Emissivity Surface 4 | Emissivity Surface 5 | Emissivity Surface 6 | Tint | Spacer | Grid Type | Grid Size | U-Factor (Btu/h-ft <sup>2</sup> -F) | SHGC | VT   | *CR |
|--|----------------|------------|------------|------------|------------|----------------------|----------------------|----------------------|----------------------|----------------------|------|--------|-----------|-----------|-------------------------------------|------|------|-----|
| 270-arg97-CCI 3-3, ga                          | 0001           | 0.65       |            | ARG        |            | 0.035                |                      |                      |                      |                      | CL   | SP-D   | N         |           | 0.27                                | 0.29 | 0.54 | 61  |
| 270-arg97-CCI 3-3, ga, Rectangular             |                | 0.65       |            | ARG        |            | 0.035                |                      |                      |                      |                      | CL   | SP-D   | G         | 0.75      | 0.27                                | 0.26 | 0.49 | 61  |
| 270-arg97-CCI 4-4, ga                          | 0002           | 0.57       |            | ARG        |            | 0.035                |                      |                      |                      |                      | CL   | SP-D   | N         |           | 0.27                                | 0.28 | 0.54 | 60  |
| 270-arg97-CCI 4-4, ga, Rectangular             |                | 0.57       |            | ARG        |            | 0.035                |                      |                      |                      |                      | CL   | SP-D   | G         | 0.75      | 0.27                                | 0.26 | 0.48 | 60  |
| 270-arg97-CCI 5-5, ga                          | 0003           | 0.49       |            | ARG        |            | 0.035                |                      |                      |                      |                      | CL   | SP-D   | N         |           | 0.26                                | 0.28 | 0.53 | 59  |
| 270-arg97-CCI 5-5, ga, Rectangular             |                | 0.49       |            | ARG        |            | 0.035                |                      |                      |                      |                      | CL   | SP-D   | G         | 0.75      | 0.26                                | 0.26 | 0.47 | 59  |
| 366-arg97-CCI 3-3, ga                          | 0004           | 0.65       |            | ARG        |            | 0.020                |                      |                      |                      |                      | CL   | SP-D   | N         |           | 0.26                                | 0.21 | 0.50 | 61  |
| 366-arg97-CCI 3-3, ga, Rectangular             |                | 0.65       |            | ARG        |            | 0.020                |                      |                      |                      |                      | CL   | SP-D   | G         | 0.75      | 0.26                                | 0.19 | 0.45 | 61  |
| 366-arg97-CCI 4-4, ga                          | 0005           | 0.57       |            | ARG        |            | 0.020                |                      |                      |                      |                      | CL   | SP-D   | N         |           | 0.26                                | 0.21 | 0.50 | 60  |
| 366-arg97-CCI 4-4, ga, Rectangular             |                | 0.57       |            | ARG        |            | 0.020                |                      |                      |                      |                      | CL   | SP-D   | G         | 0.75      | 0.26                                | 0.19 | 0.45 | 60  |
| 366-arg97-CCI 5-5, ga                          | 0006           | 0.49       |            | ARG        |            | 0.020                |                      |                      |                      |                      | CL   | SP-D   | N         |           | 0.26                                | 0.22 | 0.50 | 59  |
| 366-arg97-CCI 5-5, ga, Rectangular             |                | 0.49       |            | ARG        |            | 0.020                |                      |                      |                      |                      | CL   | SP-D   | G         | 0.75      | 0.26                                | 0.19 | 0.44 | 59  |
| 180-arg97-i89 3-3, ga                          | 0007           | 0.65       |            | ARG        |            | 0.068                | 0.149                |                      |                      |                      | CL   | SP-D   | N         |           | 0.23                                | 0.49 | 0.60 | 47  |
| 180-arg97-i89 3-3, ga, Rectangular             |                | 0.65       |            | ARG        |            | 0.068                | 0.149                |                      |                      |                      | CL   | SP-D   | G         | 0.75      | 0.23                                | 0.44 | 0.54 | 47  |
| 180-arg97-i89 4-4, ga                          | 0008           | 0.57       |            | ARG        |            | 0.068                | 0.149                |                      |                      |                      | CL   | SP-D   | N         |           | 0.23                                | 0.48 | 0.60 | 46  |
| 180-arg97-i89 4-4, ga, Rectangular             |                | 0.57       |            | ARG        |            | 0.068                | 0.149                |                      |                      |                      | CL   | SP-D   | G         | 0.75      | 0.23                                | 0.43 | 0.53 | 46  |
| 270-arg97-CCI-arg97-CCI 3-3-3, ga              | 0009           | 0.45       | 0.45       | ARG        | ARG        | 0.035                |                      |                      |                      |                      | CL   | SP-D   | N         |           | 0.21                                | 0.27 | 0.50 | 68  |
| 270-arg97-CCI-arg97-CCI 3-3-3, ga, Rectangular | 0010           | 0.45       | 0.45       | ARG        | ARG        | 0.035                |                      |                      |                      |                      | CL   | SP-D   | G         | 0.75      | 0.22                                | 0.24 | 0.44 | 68  |
| 270-arg97-CCI-arg97-270 3-3-3, ga              | 0011           | 0.45       | 0.45       | ARG        | ARG        | 0.035                |                      | 0.035                |                      |                      | CL   | SP-D   | N         |           | 0.17                                | 0.25 | 0.42 | 74  |
| 270-arg97-CCI-arg97-270 3-3-3, ga, Rectangular | 0012           | 0.45       | 0.45       | ARG        | ARG        | 0.035                |                      | 0.035                |                      |                      | CL   | SP-D   | G         | 0.75      | 0.17                                | 0.22 | 0.38 | 74  |
| VCI-arg97-SG400 3-3, ga                        | 0013           | 0.65       |            | ARG        |            |                      | 0.113                |                      |                      |                      | CL   | SP-D   | N         |           | 0.29                                | 0.53 | 0.61 | 59  |
| VCI-arg97-SG400 3-3, ga, Rectangular           |                | 0.65       |            | ARG        |            |                      | 0.113                |                      |                      |                      | CL   | SP-D   | G         | 0.75      | 0.29                                | 0.48 | 0.54 | 59  |
| VCI-arg97-SG400 4-4, ga                        | 0014           | 0.57       |            | ARG        |            |                      | 0.113                |                      |                      |                      | CL   | SP-D   | N         |           | 0.29                                | 0.52 | 0.61 | 58  |
| VCI-arg97-SG400 4-4, ga, Rectangular           |                | 0.57       |            | ARG        |            |                      | 0.113                |                      |                      |                      | CL   | SP-D   | G         | 0.75      | 0.29                                | 0.47 | 0.54 | 58  |
| VCI-arg97-SG400 5-5, ga                        | 0015           | 0.49       |            | ARG        |            |                      | 0.113                |                      |                      |                      | CL   | SP-D   | N         |           | 0.28                                | 0.51 | 0.60 | 57  |
| VCI-arg97-SG400 5-5, ga, Rectangular           |                | 0.49       |            | ARG        |            |                      | 0.113                |                      |                      |                      | CL   | SP-D   | G         | 0.75      | 0.28                                | 0.46 | 0.53 | 57  |
| 270-arg97-CCI 3-3, im                          | 0016           | 0.65       |            | ARG        |            | 0.035                |                      |                      |                      |                      | CL   | TS-D   | N         |           | 0.27                                | 0.29 | 0.54 | 59  |
| 270-arg97-CCI 3-3, im, Rectangular             |                | 0.65       |            | ARG        |            | 0.035                |                      |                      |                      |                      | CL   | TS-D   | G         | 0.75      | 0.27                                | 0.26 | 0.49 | 59  |
| 270-arg97-CCI 4-4, im                          | 0017           | 0.56       |            | ARG        |            | 0.035                |                      |                      |                      |                      | CL   | TS-D   | N         |           | 0.27                                | 0.28 | 0.54 | 58  |
| 270-arg97-CCI 4-4, im, Rectangular             |                | 0.56       |            | ARG        |            | 0.035                |                      |                      |                      |                      | CL   | TS-D   | G         | 0.75      | 0.27                                | 0.26 | 0.48 | 58  |
| 270-arg97-CCI 5-5, im                          | 0018           | 0.48       |            | ARG        |            | 0.035                |                      |                      |                      |                      | CL   | TS-D   | N         |           | 0.27                                | 0.28 | 0.53 | 57  |

| Mfr Product Code                                | Product Number | Gap 1 (in) | Gap 2 (in) | Gap Fill 1 | Gap Fill 2 | Emissivity Surface 2 | Emissivity Surface 3 | Emissivity Surface 4 | Emissivity Surface 5 | Emissivity Surface 6 | Tint | Spacer | Grid Type | Grid Size | U-Factor (Btu/h*fe2f) | SHGC | VT   | *CR |
|---|----------------|------------|------------|------------|------------|----------------------|----------------------|----------------------|----------------------|----------------------|------|--------|-----------|-----------|-----------------------|------|------|-----|
| 270-arg97-CCI 5-5 , im, Rectangular             |                | 0.48       |            | ARG        |            | 0.035                |                      |                      |                      |                      | CL   | TS-D   | G         | 0.75      | 0.27                  | 0.26 | 0.47 | 57  |
| 366-arg97-CCI 3-3 , im                          | 0019           | 0.65       |            | ARG        |            | 0.020                |                      |                      |                      |                      | CL   | TS-D   | N         |           | 0.27                  | 0.21 | 0.50 | 60  |
| 366-arg97-CCI 3-3 , im, Rectangular             |                | 0.65       |            | ARG        |            | 0.020                |                      |                      |                      |                      | CL   | TS-D   | G         | 0.75      | 0.27                  | 0.19 | 0.45 | 60  |
| 366-arg97-CCI 4-4 , im                          | 0020           | 0.56       |            | ARG        |            | 0.020                |                      |                      |                      |                      | CL   | TS-D   | N         |           | 0.26                  | 0.21 | 0.50 | 58  |
| 366-arg97-CCI 4-4 , im, Rectangular             |                | 0.56       |            | ARG        |            | 0.020                |                      |                      |                      |                      | CL   | TS-D   | G         | 0.75      | 0.26                  | 0.19 | 0.45 | 58  |
| 366-arg97-CCI 5-5 , im                          | 0021           | 0.48       |            | ARG        |            | 0.020                |                      |                      |                      |                      | CL   | TS-D   | N         |           | 0.26                  | 0.22 | 0.50 | 57  |
| 366-arg97-CCI 5-5 , im, Rectangular             |                | 0.48       |            | ARG        |            | 0.020                |                      |                      |                      |                      | CL   | TS-D   | G         | 0.75      | 0.26                  | 0.20 | 0.44 | 57  |
| 180-arg97-i89 3-3 , im                          | 0022           | 0.65       |            | ARG        |            | 0.068                |                      | 0.149                |                      |                      | CL   | TS-D   | N         |           | 0.24                  | 0.49 | 0.60 | 46  |
| 180-arg97-i89 3-3 , im, Rectangular             |                | 0.65       |            | ARG        |            | 0.068                |                      | 0.149                |                      |                      | CL   | TS-D   | G         | 0.75      | 0.24                  | 0.44 | 0.54 | 46  |
| 180-arg97-i89 4-4 , im                          | 0023           | 0.56       |            | ARG        |            | 0.068                |                      | 0.149                |                      |                      | CL   | TS-D   | N         |           | 0.23                  | 0.48 | 0.60 | 45  |
| 180-arg97-i89 4-4 , im, Rectangular             |                | 0.56       |            | ARG        |            | 0.068                |                      | 0.149                |                      |                      | CL   | TS-D   | G         | 0.75      | 0.23                  | 0.43 | 0.53 | 45  |
| 270-arg97-CCI-arg97-CCI 3-3-3 , im              | 0024           | 0.46       | 0.46       | ARG        | ARG        | 0.035                |                      |                      |                      |                      | CL   | TS-D   | N         |           | 0.22                  | 0.27 | 0.50 | 66  |
| 270-arg97-CCI-arg97-CCI 3-3-3 , im, Rectangular | 0025           | 0.46       | 0.46       | ARG        | ARG        | 0.035                |                      |                      |                      |                      | CL   | TS-D   | G         | 0.75      | 0.22                  | 0.24 | 0.44 | 66  |
| 270-arg97-CCI-arg97-270 3-3-3 , im              | 0026           | 0.46       | 0.46       | ARG        | ARG        | 0.035                |                      |                      | 0.035                |                      | CL   | TS-D   | N         |           | 0.17                  | 0.25 | 0.42 | 72  |
| 270-arg97-CCI-arg97-270 3-3-3 , im, Rectangular | 0027           | 0.46       | 0.46       | ARG        | ARG        | 0.035                |                      |                      | 0.035                |                      | CL   | TS-D   | G         | 0.75      | 0.17                  | 0.22 | 0.38 | 72  |
| VCI-arg97-SG400 3-3 , im                        | 0028           | 0.65       |            | ARG        |            |                      | 0.113                |                      |                      |                      | CL   | TS-D   | N         |           | 0.29                  | 0.53 | 0.61 | 58  |
| VCI-arg97-SG400 3-3 , im, Rectangular           |                | 0.65       |            | ARG        |            |                      | 0.113                |                      |                      |                      | CL   | TS-D   | G         | 0.75      | 0.29                  | 0.48 | 0.54 | 58  |
| VCI-arg97-SG400 4-4 , im                        | 0029           | 0.56       |            | ARG        |            |                      | 0.113                |                      |                      |                      | CL   | TS-D   | N         |           | 0.29                  | 0.52 | 0.61 | 56  |
| VCI-arg97-SG400 4-4 , im, Rectangular           |                | 0.56       |            | ARG        |            |                      | 0.113                |                      |                      |                      | CL   | TS-D   | G         | 0.75      | 0.29                  | 0.47 | 0.54 | 56  |
| VCI-arg97-SG400 5-5 , im                        | 0030           | 0.48       |            | ARG        |            |                      | 0.113                |                      |                      |                      | CL   | TS-D   | N         |           | 0.29                  | 0.51 | 0.60 | 55  |
| VCI-arg97-SG400 5-5 , im, Rectangular           |                | 0.48       |            | ARG        |            |                      | 0.113                |                      |                      |                      | CL   | TS-D   | G         | 0.75      | 0.29                  | 0.46 | 0.53 | 55  |

**DIRECT SET PICTURE WINDOW**

| Mfr Product Code                               | Product Number | Gap 1 (in) | Gap 2 (in) | Gap Fill 1 | Gap Fill 2 | Emissivity Surface 2 | Emissivity Surface 3 | Emissivity Surface 4 | Emissivity Surface 5 | Emissivity Surface 6 | Tint | Spacer | Grid Type | Grid Size | U-Factor (Btu/h*F <sup>2</sup> ) | SHGC | VT   | *CR |
|--|----------------|------------|------------|------------|------------|----------------------|----------------------|----------------------|----------------------|----------------------|------|--------|-----------|-----------|----------------------------------|------|------|-----|
| CCI-arg97-180 3-3, ga                          | 0001           | 0.65       |            | ARG        |            | 0.068                |                      |                      |                      |                      | CL   | SP-D   | N         |           | 0.27                             | 0.57 | 0.65 | 62  |
| CCI-arg97-180 3-3, ga, Rectangular             |                | 0.65       |            | ARG        |            | 0.068                |                      |                      |                      |                      | CL   | SP-D   | G 0.75    |           | 0.27                             | 0.51 | 0.58 | 62  |
| CCI-arg97-180 4-4, ga                          | 0002           | 0.57       |            | ARG        |            | 0.068                |                      |                      |                      |                      | CL   | SP-D   | N         |           | 0.27                             | 0.55 | 0.65 | 61  |
| CCI-arg97-180 4-4, ga, Rectangular             |                | 0.57       |            | ARG        |            | 0.068                |                      |                      |                      |                      | CL   | SP-D   | G 0.75    |           | 0.27                             | 0.50 | 0.58 | 61  |
| CCI-arg97-180 5-5, ga                          | 0003           | 0.49       |            | ARG        |            | 0.068                |                      |                      |                      |                      | CL   | SP-D   | N         |           | 0.27                             | 0.54 | 0.64 | 60  |
| CCI-arg97-180 5-5, ga, Rectangular             |                | 0.49       |            | ARG        |            | 0.068                |                      |                      |                      |                      | CL   | SP-D   | G 0.75    |           | 0.27                             | 0.49 | 0.57 | 60  |
| 270-arg97-CCI 3-3, ga                          | 0004           | 0.65       |            | ARG        |            | 0.035                |                      |                      |                      |                      | CL   | SP-D   | N         |           | 0.26                             | 0.30 | 0.58 | 63  |
| 270-arg97-CCI 3-3, ga, Rectangular             |                | 0.65       |            | ARG        |            | 0.035                |                      |                      |                      |                      | CL   | SP-D   | G 0.75    |           | 0.26                             | 0.27 | 0.52 | 63  |
| 270-arg97-CCI 4-4, ga                          | 0005           | 0.57       |            | ARG        |            | 0.035                |                      |                      |                      |                      | CL   | SP-D   | N         |           | 0.26                             | 0.30 | 0.57 | 62  |
| 270-arg97-CCI 4-4, ga, Rectangular             |                | 0.57       |            | ARG        |            | 0.035                |                      |                      |                      |                      | CL   | SP-D   | G 0.75    |           | 0.26                             | 0.27 | 0.51 | 62  |
| 270-arg97-CCI 5-5, ga                          | 0006           | 0.49       |            | ARG        |            | 0.035                |                      |                      |                      |                      | CL   | SP-D   | N         |           | 0.26                             | 0.30 | 0.56 | 61  |
| 270-arg97-CCI 5-5, ga, Rectangular             |                | 0.49       |            | ARG        |            | 0.035                |                      |                      |                      |                      | CL   | SP-D   | G 0.75    |           | 0.26                             | 0.27 | 0.50 | 61  |
| 366-arg97-CCI 3-3, ga                          | 0007           | 0.65       |            | ARG        |            | 0.020                |                      |                      |                      |                      | CL   | SP-D   | N         |           | 0.26                             | 0.22 | 0.53 | 63  |
| 366-arg97-CCI 3-3, ga, Rectangular             |                | 0.65       |            | ARG        |            | 0.020                |                      |                      |                      |                      | CL   | SP-D   | G 0.75    |           | 0.26                             | 0.20 | 0.48 | 63  |
| 366-arg97-CCI 4-4, ga                          | 0008           | 0.57       |            | ARG        |            | 0.020                |                      |                      |                      |                      | CL   | SP-D   | N         |           | 0.26                             | 0.23 | 0.53 | 62  |
| 366-arg97-CCI 4-4, ga, Rectangular             |                | 0.57       |            | ARG        |            | 0.020                |                      |                      |                      |                      | CL   | SP-D   | G 0.75    |           | 0.26                             | 0.20 | 0.47 | 62  |
| 366-arg97-CCI 5-5, ga                          | 0009           | 0.49       |            | ARG        |            | 0.020                |                      |                      |                      |                      | CL   | SP-D   | N         |           | 0.25                             | 0.23 | 0.52 | 61  |
| 366-arg97-CCI 5-5, ga, Rectangular             |                | 0.49       |            | ARG        |            | 0.020                |                      |                      |                      |                      | CL   | SP-D   | G 0.75    |           | 0.25                             | 0.21 | 0.47 | 61  |
| 180-arg97-i89 3-3, ga                          | 0010           | 0.65       |            | ARG        |            | 0.068                | 0.149                |                      |                      |                      | CL   | SP-D   | N         |           | 0.23                             | 0.52 | 0.64 | 49  |
| 180-arg97-i89 3-3, ga, Rectangular             |                | 0.65       |            | ARG        |            | 0.068                | 0.149                |                      |                      |                      | CL   | SP-D   | G 0.75    |           | 0.23                             | 0.47 | 0.57 | 49  |
| 180-arg97-i89 4-4, ga                          | 0011           | 0.57       |            | ARG        |            | 0.068                | 0.149                |                      |                      |                      | CL   | SP-D   | N         |           | 0.23                             | 0.50 | 0.63 | 48  |
| 180-arg97-i89 4-4, ga, Rectangular             |                | 0.57       |            | ARG        |            | 0.068                | 0.149                |                      |                      |                      | CL   | SP-D   | G 0.75    |           | 0.23                             | 0.45 | 0.57 | 48  |
| 180-arg97-CCI-arg97-CCI 3-3-3, ga              | 0012           | 0.45       | 0.45       | ARG        | ARG        | 0.068                |                      |                      |                      |                      | CL   | SP-D   | N         |           | 0.21                             | 0.49 | 0.60 | 69  |
| 180-arg97-CCI-arg97-CCI 3-3-3, ga, Rectangular | 0013           | 0.45       | 0.45       | ARG        | ARG        | 0.068                |                      |                      |                      |                      | CL   | SP-D   | G 0.75    |           | 0.22                             | 0.44 | 0.53 | 69  |
| 270-arg97-CCI-arg97-180 3-3-3, ga              | 0014           | 0.45       | 0.45       | ARG        | ARG        | 0.035                |                      | 0.068                |                      |                      | CL   | SP-D   | N         |           | 0.16                             | 0.28 | 0.51 | 76  |
| 270-arg97-CCI-arg97-180 3-3-3, ga, Rectangular | 0015           | 0.45       | 0.45       | ARG        | ARG        | 0.035                |                      | 0.068                |                      |                      | CL   | SP-D   | G 0.75    |           | 0.16                             | 0.25 | 0.45 | 76  |
| 270-arg97-CCI-arg97-CCI 3-3-3, ga              | 0016           | 0.45       | 0.45       | ARG        | ARG        | 0.035                |                      |                      |                      |                      | CL   | SP-D   | N         |           | 0.20                             | 0.28 | 0.53 | 70  |
| 270-arg97-CCI-arg97-CCI 3-3-3, ga, Rectangular | 0017           | 0.45       | 0.45       | ARG        | ARG        | 0.035                |                      |                      |                      |                      | CL   | SP-D   | G 0.75    |           | 0.21                             | 0.26 | 0.47 | 70  |
| 270-arg97-CCI-arg97-270 3-3-3, ga              | 0018           | 0.45       | 0.45       | ARG        | ARG        | 0.035                |                      | 0.035                |                      |                      | CL   | SP-D   | N         |           | 0.16                             | 0.26 | 0.45 | 76  |
| 270-arg97-CCI-arg97-270 3-3-3, ga, Rectangular | 0019           | 0.45       | 0.45       | ARG        | ARG        | 0.035                |                      | 0.035                |                      |                      | CL   | SP-D   | G 0.75    |           | 0.16                             | 0.23 | 0.40 | 76  |
| 366-arg97-CCI-arg97-CCI 3-3-3, ga              | 0020           | 0.45       | 0.45       | ARG        | ARG        | 0.020                |                      |                      |                      |                      | CL   | SP-D   | N         |           | 0.20                             | 0.21 | 0.49 | 70  |

| Mfr Product Code                               | Product Number | Gap 1 (in) | Gap 2 (in) | Gap Fill 1 | Gap Fill 2 | Emissivity Surface 2 | Emissivity Surface 3 | Emissivity Surface 4 | Emissivity Surface 5 | Emissivity Surface 6 | Tint | Spacer | Grid Type | Grid Size | U-Factor (Btu/h*F <sup>2</sup> ) | SHGC | VT   | *CR |
|--|----------------|------------|------------|------------|------------|----------------------|----------------------|----------------------|----------------------|----------------------|------|--------|-----------|-----------|----------------------------------|------|------|-----|
| 366-arg97-CCI-arg97-CCI 3-3-3, ga, Rectangular | 0021           | 0.45       | 0.45       | ARG        | ARG        | 0.020                |                      |                      |                      |                      | CL   | SP-D   | G         | 0.75      | 0.21                             | 0.19 | 0.44 | 70  |
| 366-arg97-CCI-arg97-366 3-3-3, ga              | 0022           | 0.45       | 0.45       | ARG        | ARG        | 0.020                |                      |                      | 0.020                |                      | CL   | SP-D   | N         |           | 0.15                             | 0.20 | 0.38 | 76  |
| 366-arg97-CCI-arg97-366 3-3-3, ga, Rectangular | 0023           | 0.45       | 0.45       | ARG        | ARG        | 0.020                |                      |                      | 0.020                |                      | CL   | SP-D   | G         | 0.75      | 0.16                             | 0.18 | 0.34 | 76  |
| VCI-arg97-SG400 3-3, ga                        | 0024           | 0.65       |            | ARG        |            |                      | 0.113                |                      |                      |                      | CL   | SP-D   | N         |           | 0.29                             | 0.56 | 0.65 | 61  |
| VCI-arg97-SG400 3-3, Rectangular               |                | 0.65       |            | ARG        |            |                      | 0.113                |                      |                      |                      | CL   | SP-D   | G         | 0.75      | 0.29                             | 0.51 | 0.58 | 61  |
| VCI-arg97-SG400 4-4, ga                        | 0025           | 0.57       |            | ARG        |            |                      | 0.113                |                      |                      |                      | CL   | SP-D   | N         |           | 0.29                             | 0.55 | 0.64 | 60  |
| VCI-arg97-SG400 4-4, ga, Rectangular           |                | 0.57       |            | ARG        |            |                      | 0.113                |                      |                      |                      | CL   | SP-D   | G         | 0.75      | 0.29                             | 0.50 | 0.57 | 60  |
| VCI-arg97-SG400 5-5, ga                        | 0026           | 0.49       |            | ARG        |            |                      | 0.113                |                      |                      |                      | CL   | SP-D   | N         |           | 0.28                             | 0.54 | 0.64 | 59  |
| VCI-arg97-SG400 5-5, ga, Rectangular           |                | 0.49       |            | ARG        |            |                      | 0.113                |                      |                      |                      | CL   | SP-D   | G         | 0.75      | 0.28                             | 0.49 | 0.57 | 59  |
| CCI-arg97-180 3-3, im                          | 0027           | 0.65       |            | ARG        |            |                      | 0.068                |                      |                      |                      | CL   | TS-D   | N         |           | 0.28                             | 0.57 | 0.65 | 61  |
| CCI-arg97-180 3-3, im, Rectangular             |                | 0.65       |            | ARG        |            |                      | 0.068                |                      |                      |                      | CL   | TS-D   | G         | 0.75      | 0.28                             | 0.51 | 0.58 | 61  |
| CCI-arg97-180 4-4, im                          | 0028           | 0.56       |            | ARG        |            |                      | 0.068                |                      |                      |                      | CL   | TS-D   | N         |           | 0.27                             | 0.55 | 0.65 | 60  |
| CCI-arg97-180 4-4, im, Rectangular             |                | 0.56       |            | ARG        |            |                      | 0.068                |                      |                      |                      | CL   | TS-D   | G         | 0.75      | 0.27                             | 0.50 | 0.58 | 60  |
| CCI-arg97-180 5-5, im                          | 0029           | 0.48       |            | ARG        |            |                      | 0.068                |                      |                      |                      | CL   | TS-D   | N         |           | 0.27                             | 0.54 | 0.64 | 59  |
| CCI-arg97-180 5-5, im, Rectangular             |                | 0.48       |            | ARG        |            |                      | 0.068                |                      |                      |                      | CL   | TS-D   | G         | 0.75      | 0.27                             | 0.49 | 0.57 | 59  |
| 270-arg97-CCI 3-3, im                          | 0030           | 0.65       |            | ARG        |            | 0.035                |                      |                      |                      |                      | CL   | TS-D   | N         |           | 0.27                             | 0.30 | 0.58 | 62  |
| 270-arg97-CCI 3-3, im, Rectangular             |                | 0.65       |            | ARG        |            | 0.035                |                      |                      |                      |                      | CL   | TS-D   | G         | 0.75      | 0.27                             | 0.27 | 0.52 | 62  |
| 270-arg97-CCI 4-4, im                          | 0031           | 0.56       |            | ARG        |            | 0.035                |                      |                      |                      |                      | CL   | TS-D   | N         |           | 0.26                             | 0.30 | 0.57 | 60  |
| 270-arg97-CCI 4-4, im, Rectangular             |                | 0.56       |            | ARG        |            | 0.035                |                      |                      |                      |                      | CL   | TS-D   | G         | 0.75      | 0.26                             | 0.27 | 0.51 | 60  |
| 270-arg97-CCI 5-5, im                          | 0032           | 0.48       |            | ARG        |            | 0.035                |                      |                      |                      |                      | CL   | TS-D   | N         |           | 0.26                             | 0.30 | 0.56 | 59  |
| 270-arg97-CCI 5-5, im, Rectangular             |                | 0.48       |            | ARG        |            | 0.035                |                      |                      |                      |                      | CL   | TS-D   | G         | 0.75      | 0.26                             | 0.27 | 0.50 | 59  |
| 366-arg97-CCI 3-3, im                          | 0033           | 0.65       |            | ARG        |            | 0.020                |                      |                      |                      |                      | CL   | TS-D   | N         |           | 0.26                             | 0.22 | 0.53 | 62  |
| 366-arg97-CCI 3-3, im, Rectangular             |                | 0.65       |            | ARG        |            | 0.020                |                      |                      |                      |                      | CL   | TS-D   | G         | 0.75      | 0.26                             | 0.20 | 0.48 | 62  |
| 366-arg97-CCI 4-4, im                          | 0034           | 0.56       |            | ARG        |            | 0.020                |                      |                      |                      |                      | CL   | TS-D   | N         |           | 0.26                             | 0.23 | 0.53 | 61  |
| 366-arg97-CCI 4-4, im, Rectangular             |                | 0.56       |            | ARG        |            | 0.020                |                      |                      |                      |                      | CL   | TS-D   | G         | 0.75      | 0.26                             | 0.20 | 0.47 | 61  |
| 366-arg97-CCI 5-5, im                          | 0035           | 0.48       |            | ARG        |            | 0.020                |                      |                      |                      |                      | CL   | TS-D   | N         |           | 0.26                             | 0.23 | 0.52 | 60  |
| 366-arg97-CCI 5-5, im, Rectangular             |                | 0.48       |            | ARG        |            | 0.020                |                      |                      |                      |                      | CL   | TS-D   | G         | 0.75      | 0.26                             | 0.21 | 0.47 | 60  |
| 180-arg97-i89 3-3, im                          | 0036           | 0.65       |            | ARG        |            | 0.068                | 0.149                |                      |                      |                      | CL   | TS-D   | N         |           | 0.23                             | 0.52 | 0.64 | 48  |
| 180-arg97-i89 3-3, im, Rectangular             |                | 0.65       |            | ARG        |            | 0.068                | 0.149                |                      |                      |                      | CL   | TS-D   | G         | 0.75      | 0.23                             | 0.47 | 0.57 | 48  |
| 180-arg97-i89 4-4, im                          | 0037           | 0.56       |            | ARG        |            | 0.068                | 0.149                |                      |                      |                      | CL   | TS-D   | N         |           | 0.23                             | 0.50 | 0.63 | 47  |
| 180-arg97-i89 4-4, im, Rectangular             |                | 0.56       |            | ARG        |            | 0.068                | 0.149                |                      |                      |                      | CL   | TS-D   | G         | 0.75      | 0.23                             | 0.45 | 0.57 | 47  |
| 180-arg97-CCI-arg97-CCI 3-3-3, im              | 0038           | 0.46       | 0.46       | ARG        | ARG        | 0.068                |                      |                      |                      |                      | CL   | TS-D   | N         |           | 0.21                             | 0.49 | 0.60 | 68  |
| 180-arg97-CCI-arg97-CCI 3-3-3, im, Rectangular | 0039           | 0.46       | 0.46       | ARG        | ARG        | 0.068                |                      |                      |                      |                      | CL   | TS-D   | G         | 0.75      | 0.22                             | 0.44 | 0.53 | 68  |
| 270-arg97-CCI-arg97-180 3-3-3, im              | 0040           | 0.46       | 0.46       | ARG        | ARG        | 0.035                |                      |                      | 0.068                |                      | CL   | TS-D   | N         |           | 0.16                             | 0.27 | 0.51 | 74  |
| 270-arg97-CCI-arg97-180 3-3-3, im, Rectangular | 0041           | 0.46       | 0.46       | ARG        | ARG        | 0.035                |                      |                      | 0.068                |                      | CL   | TS-D   | G         | 0.75      | 0.17                             | 0.25 | 0.45 | 74  |
| 270-arg97-CCI-arg97-CCI 3-3-3, im              | 0042           | 0.46       | 0.46       | ARG        | ARG        | 0.035                |                      |                      |                      |                      | CL   | TS-D   | N         |           | 0.21                             | 0.28 | 0.53 | 68  |
| 270-arg97-CCI-arg97-CCI 3-3-3, im, Rectangular | 0043           | 0.46       | 0.46       | ARG        | ARG        | 0.035                |                      |                      |                      |                      | CL   | TS-D   | G         | 0.75      | 0.21                             | 0.26 | 0.47 | 68  |
| 270-arg97-CCI-arg97-270 3-3-3, im              | 0044           | 0.46       | 0.46       | ARG        | ARG        | 0.035                |                      |                      | 0.035                |                      | CL   | TS-D   | N         |           | 0.16                             | 0.26 | 0.45 | 74  |
| 270-arg97-CCI-arg97-270 3-3-3, im, Rectangular | 0045           | 0.46       | 0.46       | ARG        | ARG        | 0.035                |                      |                      | 0.035                |                      | CL   | TS-D   | G         | 0.75      | 0.16                             | 0.23 | 0.40 | 74  |
| 366-arg97-CCI-arg97-CCI 3-3-3, im              | 0046           | 0.46       | 0.46       | ARG        | ARG        | 0.020                |                      |                      |                      |                      | CL   | TS-D   | N         |           | 0.20                             | 0.21 | 0.49 | 69  |
| 366-arg97-CCI-arg97-CCI 3-3-3, im, Rectangular | 0047           | 0.46       | 0.46       | ARG        | ARG        | 0.020                |                      |                      |                      |                      | CL   | TS-D   | G         | 0.75      | 0.21                             | 0.19 | 0.44 | 69  |
| 366-arg97-CCI-arg97-366 3-3-3, im              | 0048           | 0.46       | 0.46       | ARG        | ARG        | 0.020                |                      |                      | 0.020                |                      | CL   | TS-D   | N         |           | 0.16                             | 0.20 | 0.38 | 74  |
| 366-arg97-CCI-arg97-366 3-3-3, im, Rectangular | 0049           | 0.46       | 0.46       | ARG        | ARG        | 0.020                |                      |                      | 0.020                |                      | CL   | TS-D   | G         | 0.75      | 0.16                             | 0.18 | 0.34 | 74  |
| VCI-arg97-SG400 3-3, im                        | 0050           | 0.65       |            | ARG        |            |                      | 0.113                |                      |                      |                      | CL   | TS-D   | N         |           | 0.29                             | 0.56 | 0.65 | 60  |



CROSS SECTIONS

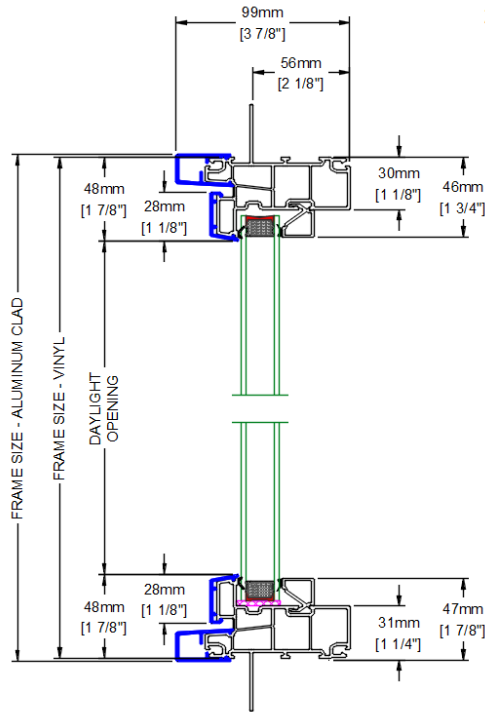

HEAD JAMB + SILL

22mm (7/8") DUAL PANE GLASS

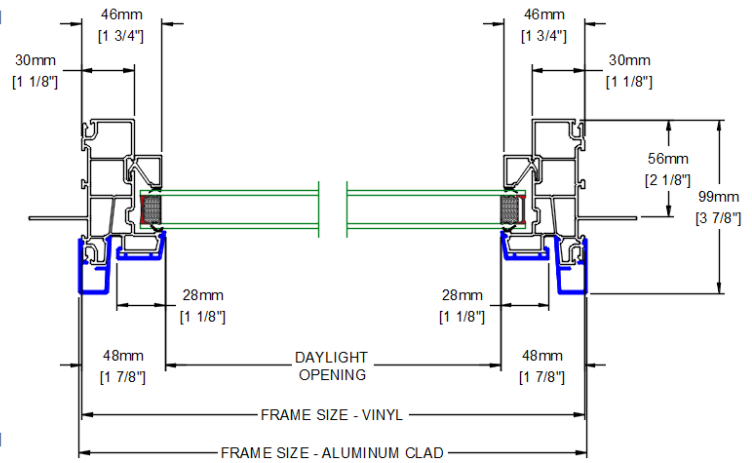

JAMBS

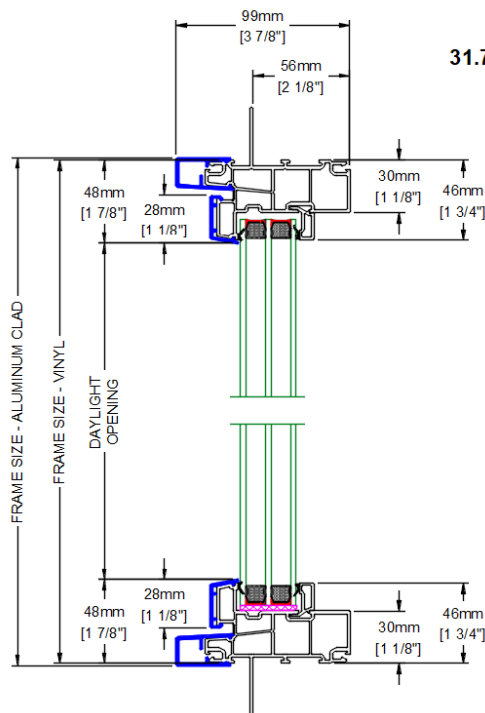

HEAD JAMB + SILL

31.75mm (1 1/4") TRIPLE PANE GLASS

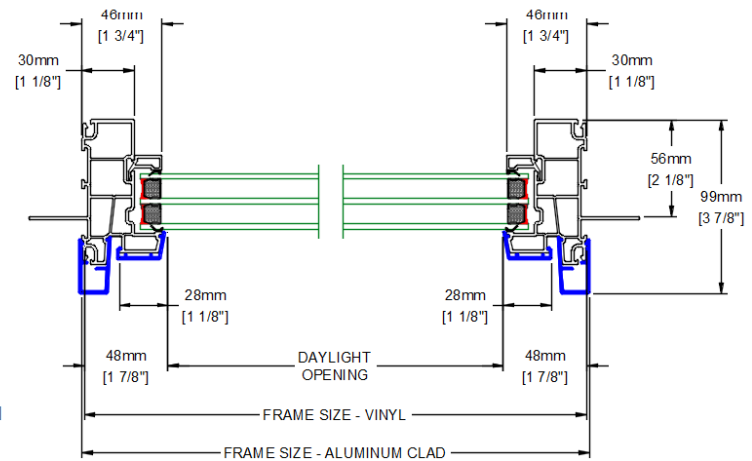

JAMBS

**HIGH FIXED PICTURE WINDOW**

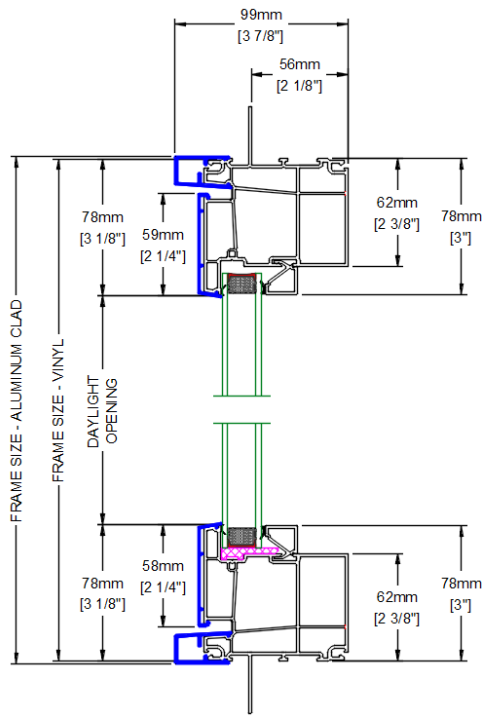

**HEAD JAMB + SILL**

**22mm (7/8") DUAL PANE GLASS**

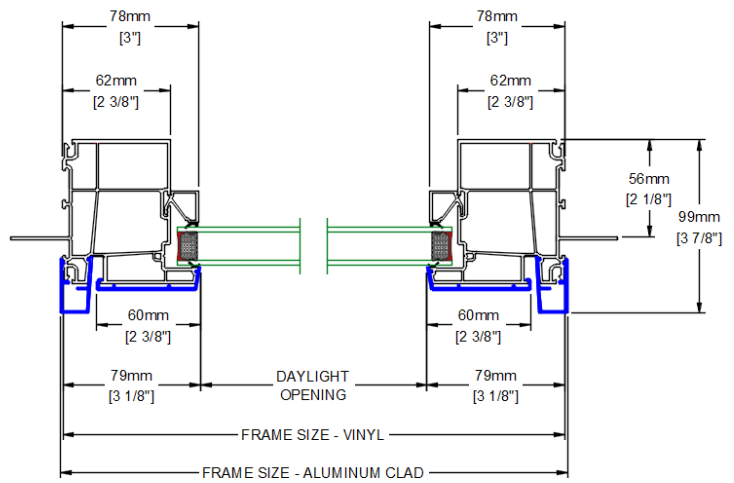

**JAMBS**

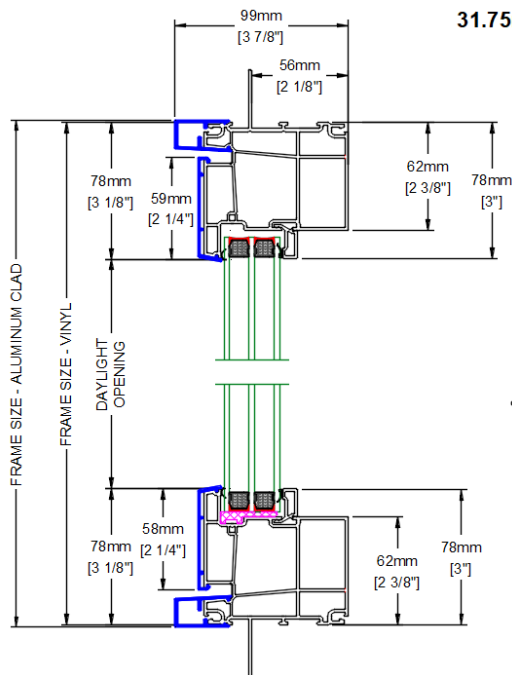

**HEAD JAMB + SILL**

**31.75mm (1 1/4") TRIPLE PANE GLASS**

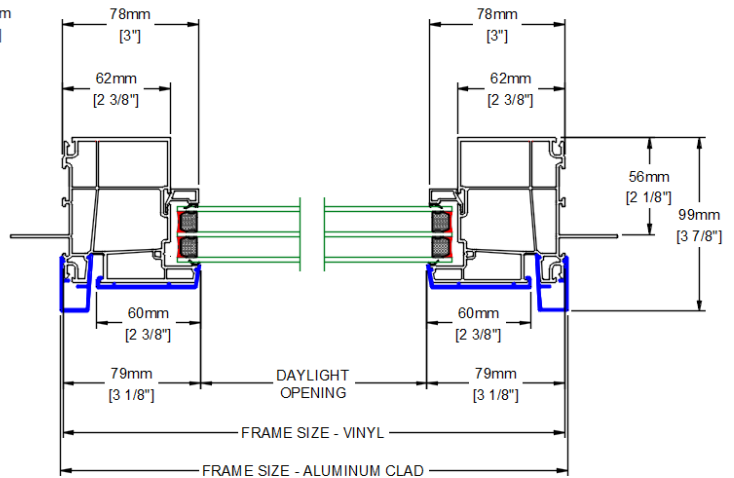

**JAMBS**

**DIRECT SET PICTURE WINDOW**

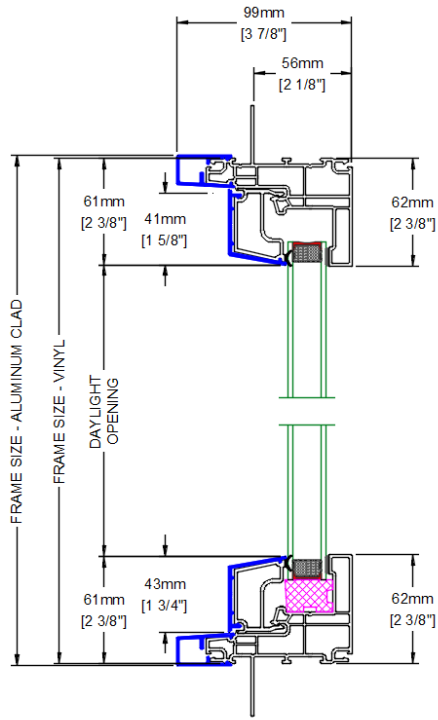

**HEAD JAMB + SILL**

**25mm (1") DUAL PANE GLASS**

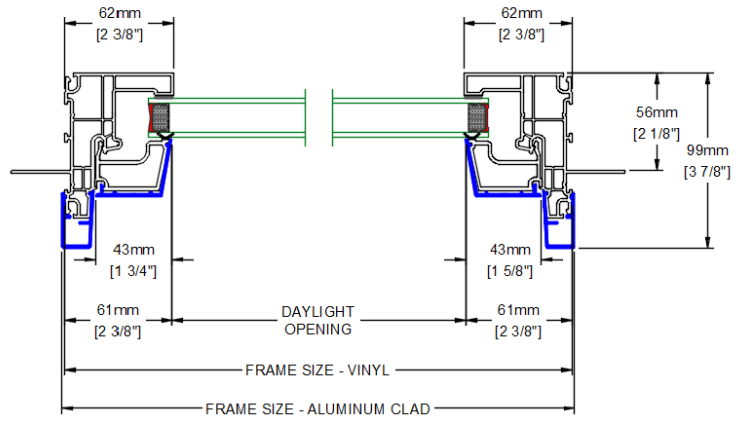

**JAMBS**

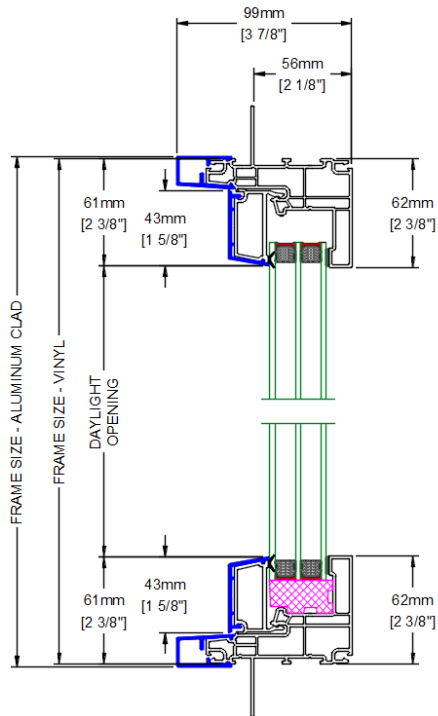

**HEAD JAMB + SILL**

**31.75mm (1 1/4") TRIPLE PANE GLASS**

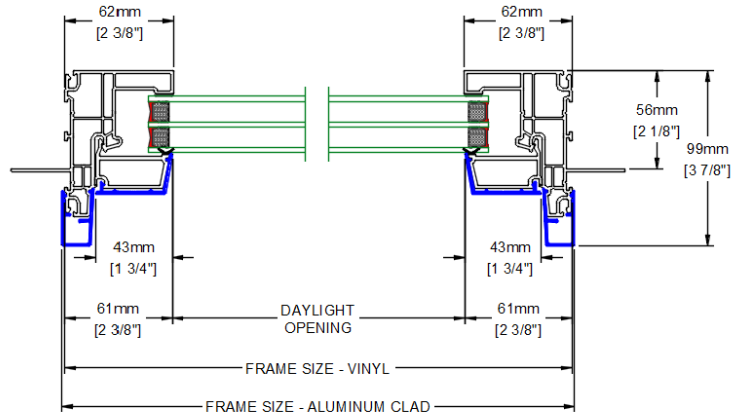

**JAMBS**

**MULLING ASSEMBLY**

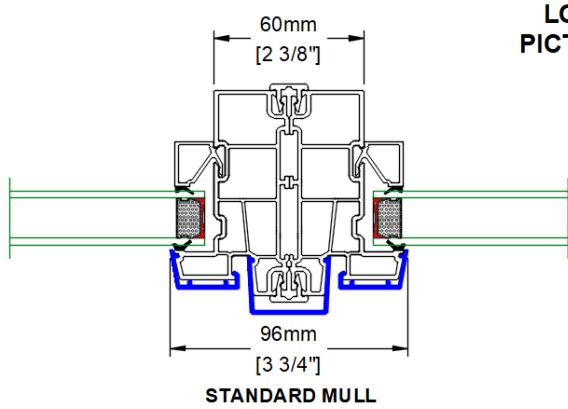

**LOW FIXED  
 PICTURE MULL**

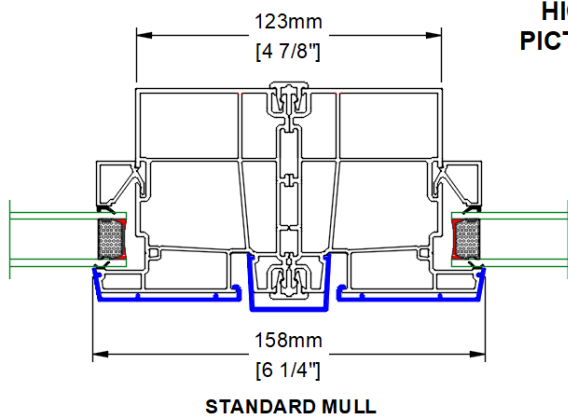
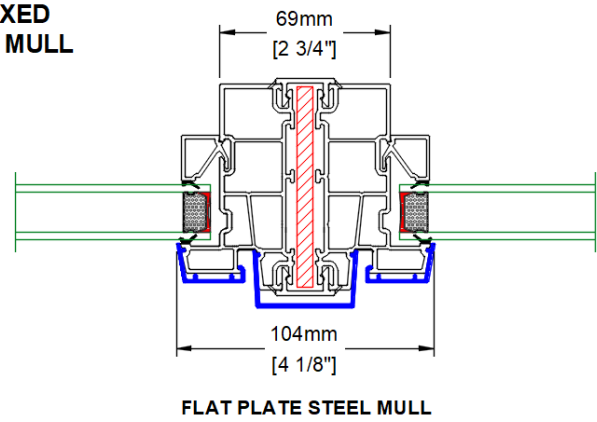

**HIGH FIXED  
 PICTURE MULL**

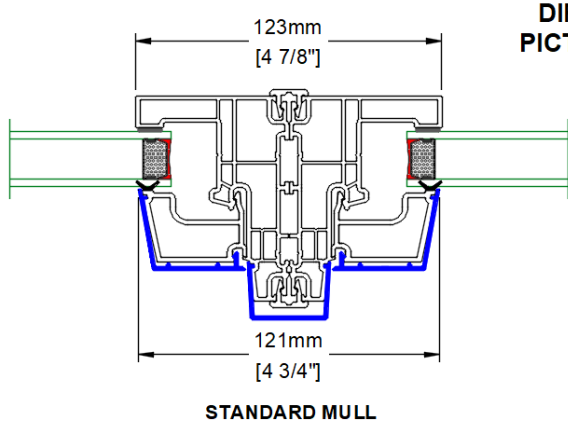
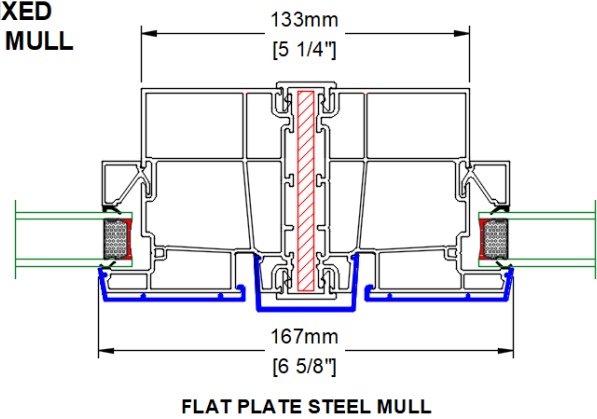

**DIRECT SET  
 PICTURE MULL**

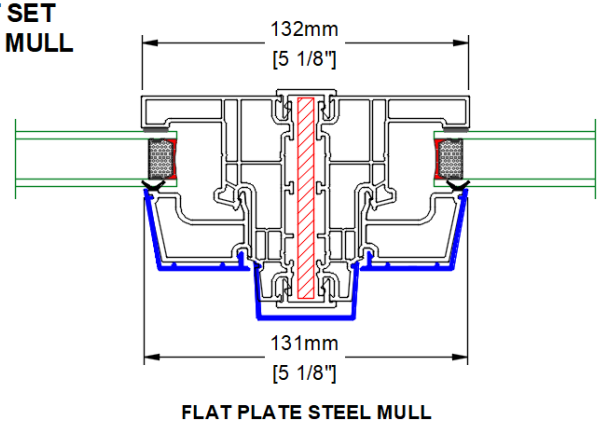

GRILL + SDL OPTIONS

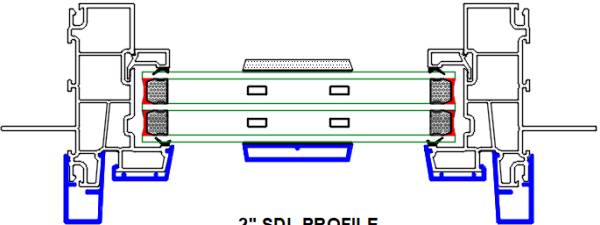
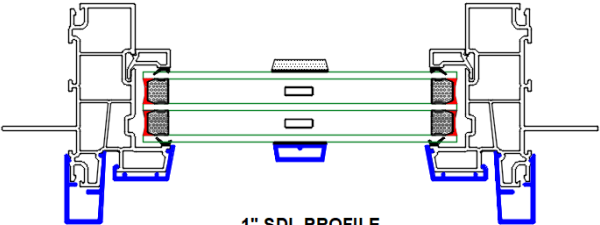
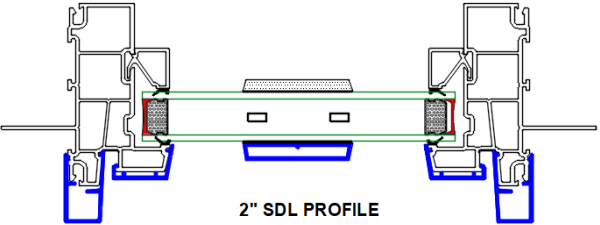
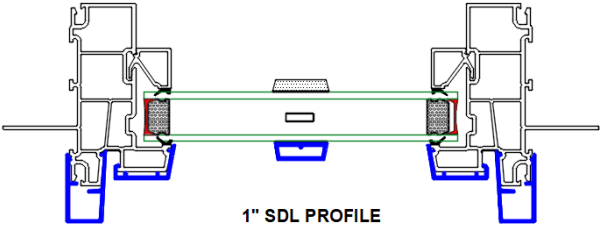
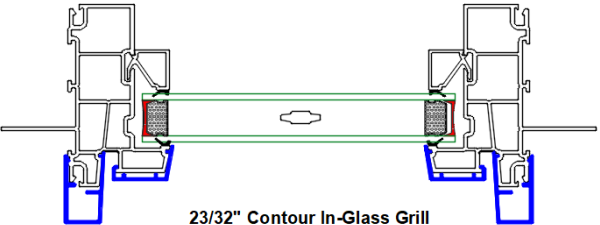
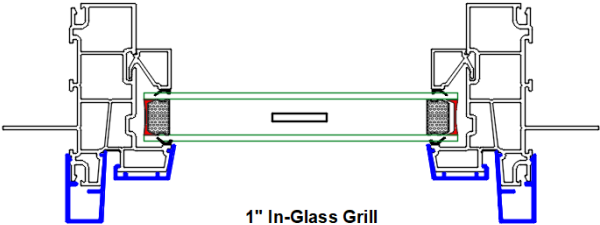
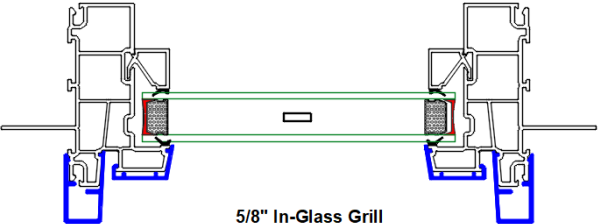
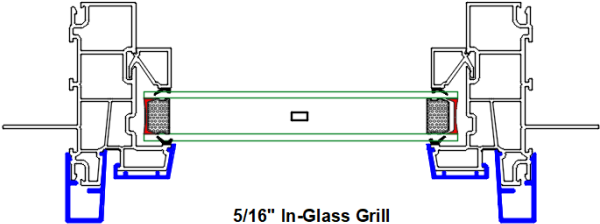

## TEST REPORTS

### PERFORMANCE TESTS IN ACCORDANCE WITH AAMA/WDMA/CSA 101/I.S.2/A440-08 & A440S1-09

|  |  |               |                  |                       |  |                             |  |                                |  |                       |            |              |            |                |   |                  |   |                          |                 |
|--|--|---------------|------------------|-----------------------|--|-----------------------------|--|--------------------------------|--|-----------------------|------------|--------------|------------|----------------|---|------------------|---|--------------------------|-----------------|
|  <p><b>Report No.:</b><br/>AI-04196-N1</p>  | <p><b>Product Manufacturer:</b></p> <p>NEXTRUSIONS<br/>10500, RUE COLBERT<br/>MONTRÉAL, QUEBEC<br/>H1J 2H8<br/>514-355-6868</p>  |               |                  |                       |  |                             |  |                                |  |                       |            |              |            |                |   |                  |   |                          |                 |
| <p><b>Test Report Summary:</b></p> <table><tr><td>Product type:</td><td>PVC Fixed Window</td></tr><tr><td>Product series/model:</td><td>3000/4000 Series Fixed Window (Small Picture) – 5 mm glass</td></tr><tr><td>Primary product designator:</td><td>Class CW-PG85-FW Size tested 1980 x 1830 (78 x 72)</td></tr><tr><td>Optional secondary designator:</td><td>Positive Design pressure (DP) = 4080 Pa (85.0 psf)<br/>Negative design pressure (DP) = -4080 Pa (-85.0 psf)<br/>Water penetration resistance test pressure = 730 Pa (15.0 psf)<br/>Canadian air infiltration / exfiltration level = Fixed Level</td></tr><tr><td>Test completion date:</td><td>09/11/2014</td></tr><tr><td>Report date:</td><td>09/24/2014</td></tr><tr><td>Revision date:</td><td>-</td></tr><tr><td>Number of pages:</td><td>5</td></tr><tr><td>CAN/CSA A440-00 ratings:</td><td>FIXED / B7 / C5</td></tr></table> <p>Note: Reference must be made to Air-Ins Inc. complete report for test specimen description and detailed test results.</p> |  | Product type: | PVC Fixed Window | Product series/model: | 3000/4000 Series Fixed Window (Small Picture) – 5 mm glass | Primary product designator: | Class CW-PG85-FW Size tested 1980 x 1830 (78 x 72) | Optional secondary designator: | Positive Design pressure (DP) = 4080 Pa (85.0 psf)<br>Negative design pressure (DP) = -4080 Pa (-85.0 psf)<br>Water penetration resistance test pressure = 730 Pa (15.0 psf)<br>Canadian air infiltration / exfiltration level = Fixed Level | Test completion date: | 09/11/2014 | Report date: | 09/24/2014 | Revision date: | - | Number of pages: | 5 | CAN/CSA A440-00 ratings: | FIXED / B7 / C5 |
| Product type:  | PVC Fixed Window   |               |                  |                       |  |                             |  |                                |  |                       |            |              |            |                |   |                  |   |                          |                 |
| Product series/model:  | 3000/4000 Series Fixed Window (Small Picture) – 5 mm glass   |               |                  |                       |  |                             |  |                                |  |                       |            |              |            |                |   |                  |   |                          |                 |
| Primary product designator:  | Class CW-PG85-FW Size tested 1980 x 1830 (78 x 72)   |               |                  |                       |  |                             |  |                                |  |                       |            |              |            |                |   |                  |   |                          |                 |
| Optional secondary designator:   | Positive Design pressure (DP) = 4080 Pa (85.0 psf)<br>Negative design pressure (DP) = -4080 Pa (-85.0 psf)<br>Water penetration resistance test pressure = 730 Pa (15.0 psf)<br>Canadian air infiltration / exfiltration level = Fixed Level |               |                  |                       |  |                             |  |                                |  |                       |            |              |            |                |   |                  |   |                          |                 |
| Test completion date:  | 09/11/2014   |               |                  |                       |  |                             |  |                                |  |                       |            |              |            |                |   |                  |   |                          |                 |
| Report date:   | 09/24/2014   |               |                  |                       |  |                             |  |                                |  |                       |            |              |            |                |   |                  |   |                          |                 |
| Revision date:   | -  |               |                  |                       |  |                             |  |                                |  |                       |            |              |            |                |   |                  |   |                          |                 |
| Number of pages:   | 5  |               |                  |                       |  |                             |  |                                |  |                       |            |              |            |                |   |                  |   |                          |                 |
| CAN/CSA A440-00 ratings:   | FIXED / B7 / C5  |               |                  |                       |  |                             |  |                                |  |                       |            |              |            |                |   |                  |   |                          |                 |

Prepared by :  
  
Digitally Signed by:  
**Éric Perron, Tech.**  
Physical Testing Department  
Air-Ins Inc.

Approved by :  
  
Digitally Signed by:  
**Jean Miller, Eng.**  
Director, Physical Testing Department  
Air-Ins Inc.

 **AIR-INS inc.**  
1320, boul. Lionel-Boulet,  
Varenes (Québec) J3X 1P7  
☎ (450) 652-0838  
☎ (450) 652-7588  
✉ info@air-ins.com



PERFORMANCE TESTING IN ACCORDANCE WITH  
 AAMA/WDMA/CSA 101/I.S.2/A440-11 (NAFS 2011) & A440S1-17

| PRODUCT MANUFACTURER   |
|--|
| <p><b>NEXTRUSIONS</b><br/>                     10500, rue Colbert<br/>                     Montréal, Québec<br/>                     H1J 2H8<br/>                     1-800-263-5546</p> |

| REPORT AI-04878-B1 |
|--------------------|
|--------------------|

| TEST REPORT SUMMARY           |  |
|-------------------------------|--|
| Product type                  | Fixed Window   |
| Product series/model          | B3000  |
| Primary product designator    | Class CW – PG60 : Size tested 1981 x 1828 mm (~ 78 x 72 in) - Type FW  |
| Optional secondary designator | Positive Design pressure (DP) = 2880 Pa (~60.15 psf)<br>Negative design pressure (DP) = -2880 Pa (~-60.15 psf)<br>Water penetration resistance test pressure = 720 Pa (~15.04 psf)<br>Canadian air infiltration / exfiltration level = FIXED Level |

See CLEB laboratory Inc. complete report AI-04878-B1 for test specimen description and detailed test results

|                      |            |                 |                      |
|----------------------|------------|-----------------|----------------------|
| Test completion date | 2018-04-24 | Number of pages | 4 pages & 1 appendix |
| Report date          | 2018-12-21 | Revision date   | -                    |

Prepared by:

**Digitally Signed by:**

Eric Perron, Tech.  
 Fenestration Testing Department  
 CLEB laboratory Inc.

Approved by:

**Digitally Signed by:**

Jean Miller, P.Eng.  
 Manager, Fenestration Testing Department  
 CLEB laboratory Inc.

LABORATORY, FIELD TESTING AND ADVISORY SERVICES FOR THE BUILDING ENVELOPE  
 30 YEARS STRONG, UL AND CLEB SERVING CUSTOMERS ACROSS NORTH AMERICA AND BEYOND

**CHICAGO**  
 US Headquarters  
 750 Anthony Trail  
 Northbrook, IL 60062  
 chicago@cleb.com

**MONTREAL**  
 Canada Headquarters  
 1320 Lionel-Boulet Blvd  
 Varennes, QC J3X 1P7  
 montreal@cleb.com

**QUEBEC**  
 420 Charest East Blvd  
 Suite 300  
 Quebec, QC G1K 8M4  
 quebec@cleb.com

**OTTAWA**  
 29 Capital Drive  
 Suite 200  
 Ottawa, ON K2G 0E7  
 ottawa@cleb.com

**TRURO**  
 64 Inglis Place  
 Suite 203  
 Truro, NS B2N 4B4  
 truro@cleb.com

**NEW YORK**  
 747 Third Avenue  
 2nd Floor  
 New York, NY 10017  
 newyork@cleb.com

T: 855.353.2532 W: ul.com/buildingenvelope